

**BASMATIA TEA ESTATE**  
**(A Government of India Enterprise)**  
**P.O. Lahoal, Dist. Dibrugarh, Assam – 786 010**

NOTICE INVITING TENDERS

**BASMATIA TEA ESTATE on behalf of ANDREW YULE & CO. LTD** invites Sealed Tender under two part system (**Part I: Techno-Commercial Bid and Part II: Price Bid**) from bona fide and reputed **Company/Firm** for **Extension of Fermenting Area and Construction of New Factory Office**, the details of which are available in Annexure-IV “**Scope of Work / Technical Specification**” as specified in this tender document.

**Schedule of Tender**

1.	<b>TENDER NO.</b>	<b>BS/CAPEX/17-18/1</b> <b>Dated. : 18.12.2017</b>
2.	<b>MODE OF TENDER</b>	<p>The Tender should be submitted in two separate parts in two separate envelop which should be put in one cover</p> <p><b>Part I - Techno-Commercial Bid</b> in separate sealed covered super scribing “Quotation for <b>Extension of Fermenting Area and Construction of New Factory Office</b>” due on 8.1.2018 (Techno-Commercial Bid). <b>Following documents are to be submitted in Techno-Commercial Bid.</b></p> <ol style="list-style-type: none"> <li>1) Duly filled / signed Annexure – I</li> <li>2) Duly signed Annexure – II as acceptance of General Terms and Conditions.</li> <li>3) Duly signed Annexure – III as acceptance to Supply Materials as per Specification mentioned in Annexure – III.</li> </ol> <p><b>Part II - Price Bid</b> in separate sealed covered super scribing “Quotation for <b>Extension of Fermenting Area and Construction of New Factory Office</b>” due on 9.1.2018 (Price Bid). <b>Following documents are to be submitted in Price Bid.</b></p> <ol style="list-style-type: none"> <li>1) Duly filled / signed Annexure – IV.</li> </ol> <p>Both the Techno-Commercial and Price Bid should be put in one cover super scribing “Quotation for <b>Extension of Fermenting Area and Construction of New Factory Office</b>” due on 9.1.2018 (Techno-Commercial and Price Bid).</p>

3.	<b>Earnest Money and other document</b>	<ul style="list-style-type: none"> <li>• <b>“Earnest Money Deposit” of Rs.4,000.00 (Rupees Four Thousand only)</b> must be paid by Cheque/D.D. favouring <b>Andrew Yule &amp; Co. Ltd. – A/c. Basmatia Tea Estate</b>, payable at Dibrugarh.</li> <li>• <b>Other document as described in Annexure – I, Sl. No. 2</b></li> </ul>
----	---	--

4.	<b>Last date of submission of EMD &amp; other documents to AYCL Ltd.</b>	<b>6.1.2018 at 3.00 p.m.</b>
5.	<b>Date &amp; time of opening of Part-I (Techno-Commercial Bid)</b>	<b>8.1.2018 at 11.00 a.m.</b>
6.	<b>Date &amp; time of opening of Part-II (Price Bid )</b>	<b>9.1.2018 at 11.00 a.m.</b>

**List of Annexure**

<b>General Information-</b>	<b>Annexure-I</b>
<b>General Terms &amp; Conditions / Scope of Work</b>	<b>Annexure-II</b>
<b>Technical Specification</b>	<b>Annexure-III</b>
<b>Price Bid Sheet</b>	<b>Annexure-IV</b>
<b>Bill Of Materials for Extension of Fermenting Area and Construction of New Factory Office</b>	<b>Annexure-V</b>
<b>Drawing for Extension of Fermenting Area and Construction of New Factory Office</b>	<b>Annexure-VI</b>

**General Information**  
**Ref. Tender No.: BS/CAPEX/17-18/1**

The applicants are required to furnish full information to the queries included in this form. In giving the particulars, the supporting documents/certificates as called for per queries at places, must be tagged with the application for evidencing the information furnished in the application.

**1. Particulars of Company**

- 1.1 Name of the Company :
- 1.2 Nature of business :
- 1.3 Full address :
- 1.4 Phone No. :
- 1.5 Fax No. :
- 1.6 E-mail ID :

**2. Details of Certificate**

SI No.	Particulars	Registration No.	Remarks
1.	Income Tax		Copy of Registration Certificate / PAN Card to be attached
2.	Trade License		Copy to be attached
3.	GST Certificate		Copy to be attached

**3. List of Local Office**

Sl. No	Location	Type of Local Office		Bidders to Provide full address & Telephone No
		Company Operated	Franchised	
1				
2				

**4. Details of Banker**

1	Name of the Bank	
2	Name of the Branch	
3	Branch Code	
4	Address	
5	IFSC Code No.	
6	Account No.	

5. List of supplies of identical :  
items made in last 2 years.  
with customer reference

6. Copies of Purchase Orders :  
received from major Customer  
for identical type of items  
(minimum 2 order copies)

I/we hereby certify that the particulars furnished by me/us above are true to the best of my / our knowledge and belief and mis-representations of facts will render me/us liable to my/our action as may be deemed fit by Andrew Yule & Co. Ltd. (Tea Division) & have the sole discretion to reject or accept my/our candidature.

Signature of the Applicant)  
Office Stamp/Seal.

Place :

Date ;

List of Enclosures :

**General Terms & Conditions****Ref. Tender No.: BS/CAPEX/17-18/1**

1. Scope of Work
  - Supply/Constructions as per specification mentioned in **Annexure-V & Annexure-VI** complete in all respect.
2. Location of Site  
Basmatia Tea Estate, P.O. Lahoal, Dibrugarh, Assam
3. Requirement  
Basmatia Tea Estate --- 01 Unit  
-----  
**TOTAL -- 01 Unit**
4. Job completion date  
The work to be completed within 90 days from date of order.
5. Liquidated Damage  
In the event of failure on the part of the contractor to complete entire work against the order to our full satisfaction within the specified period of completion, we may recover from the contractor as liquidated damages, a sum equivalent to ½% of contract value for each week or any part thereof default, but limited to a maximum of 5% of contract value. In case of any defect the contractor has to bear the cost of repairs within 1 year from date of handing over of the project.
6. Force Majeure  
Any delay or failure in the performance of either party hereto will not constitute default thereunder or give rise to any claim for damages, if any, to the extent such delays or failure of performance is caused by the occurrence such as acts of god or the public enemy, appropriation or confiscation of facilities by Govt. Authorities, acts of war, rebellion or sabotage, fires, explosions, riots and illegal strike.
7. Risk Purchase  
In case the contractor fails to execute the contract fully or partly, the purchaser shall have the right to execute the work through other agencies, as decided by the purchaser at the contractor's cost and risk after giving two weeks notice in writing.
8. Terms of payment
  - No advance will be given.
  - Part payment to be released according to the progress of work with 10% retention at each stage described in the scope of work which will be returned after 1 year of completion of the project.
  - Statutory deductions will be made as per rules.
9. Price Variation  
The quoted price should remain firm during pendency of the contract.
10. The tenderers are requested to ensure Earnest Money Deposit along with the Tender in the following manner, which will be converted into Security Deposit for the successful bidder/s and will be released on completion of delivery.  
  
EMD Amount                      Rs.4,000\_  
EMD to be submitted by D.D. favouring Andrew Yule & Co. Ltd., A/C Basmatia Tea Estate payable at Dibrugarh.
12. Decision for awarding contract/job is vested with the Management so as to reject.
13. Incomplete "Quotation/Offer" is liable to be rejected.
14. The offer must be valid for a minimum of 6 months from the date of E-Bidding.
15. All disputes are subject to Dibrugarh Jurisdiction only.

**Technical specification and requirement**

**Ref. Tender No.: BS/CAPEX/17-18/1**

Extension of Fermenting Area and Construction of New Factory Office on Trunkey basis as per **Annexure-V & Annexure-VI** adhering to appended scope of work.

**A) Scope of work – Extension of Fermenting Area and Construction of New Factory Office**

*Er. Dibya Jyoti Borah*

B. E. Civil

37, National Highway  
P.O. Moranhat - 785670, Cell : 9435976403

Specification of Work : Factory office 40'x10' at Basmati TE.

1. Providing 10 " Brick work from floor level upto 4' height where necessary including plaster in prop. 1:5 mix Volume =  $10' \times 0.75 \times 4' = 30 \text{ cft} = 0.85 \text{ m}^3$
2. Providing, fitting, fixing of ISMC 75 @10' c/c along the 10" Brick wall to support the propose aluminium sectional frame 8' above the Brick wall.
3. Providing, fitting fixing of aluminium Hollow section 3'x4' size with taper clip, rubber lining for fixing 5mm thick plane glass partition wall.= 736 sqft
4. Providing, fitting, fixing of Aluminium framed glass door at main entry to the office.
5. Providing fitting, fixing of AC board ceiling 2'x2' with G.I. T and angle framing with necessary support for holding the ceiling at proper level with the help of GI wire etc.= 465 sqft.
6. Making of RCC slab 8'x3'x3" thick size with necessary support from floor including tiles work complete.
7. Electrical wiring with copper pvc wire 2.5 mm<sup>2</sup> & 1.5 mm<sup>2</sup> with Casing ,necessary fitting complete . Total nos of points = 12 no.
8. A urinal of size 4'x5' room of 1/2 brick work adjacent to external wall should be built with water and necessary sanitary fitting with tiles on wall & floor complete.
9. Floor should fitted with 2'x2' vitrified tiles after necessary pcc work on floor.= 600 sqft
10. Painting should be done on wall , ceiling with distemper , etc.

  
**Dibya Jyoti Borah, B.E. (Civil)**  
**Regd. No. 513/91-92**  
**Consultant Engineer**  
**Andrew Yule & Co. Ltd (Assam Garden)**

The quantity envisaged has got no relevance with offer price, it is for guidance.

**Specification of the materials to be used in the project.**

<b>Sl.No</b>	<b>Description</b>
	Specification of the Materials to be used in the Project :
	Cement (53 Grade ) to be used of Brand like : ACC, TOPCEM, BIRLA GOLD
1	ETC.
2	1st Class Brick manufactured and available at Local Brick Fields
3	Sand should be coarse from riverbed.
4	Stone Chips to be used from boulder collection

**ANDREW YULE & COMPANY LIMITED**  
Tea Division

**Price Sheet for Extension of Fermenting Area and Construction of New Factory Office**  
**Ref. Tender No.: BS/CAPEX/17-18/1**

**Garden** : **Basmatia Tea Estates, Dibrugarh, Assam**

**Item** : **Extension of Fermenting Area and Construction of New Factory Office**

<b>Quantity Offered</b>	<b>Unit</b>	<b>Constructions of Extension of Fermenting Area and Construction of New Factory Office on Trunkway basis as per per Annexure-V &amp; Annexure-VI</b>	<b>Applicable Taxes</b>	<b>Unit Site Cost</b>	<b>Contract Price</b>
1		Rs.	Rs.	Rs.	Rs.
1	No				



**Annexure-V**

**BASMATIA TEA ESTATE  
Andrew Yule & Co. Ltd  
(A Government of India Enterprise)  
P.O. Laohal, Dist. Dibrugarh, Assam – 786 010**

**BILL OF MATERIALS FOR EXTENSION OF FERMENTING AREA AND CONSTRUCTION OF  
NEW FACTORY OFFICE**

**Ref. Tender No.: BS/CAPEX/17-18/1**

*Er. Dibya Jyoti Borah*

B.E. Civil

37, National Highway  
P.O. Moranhat - 785670, Cell : 9435976403

SL.No	Particulars Of Item	Qty	Unit	Rate	Amount(Rs)
1	Bricks (1st class)	1000	pcs	10.00	10000.00
2	Cement (Top cement)	30	bag	400.00	12000.00
3	Sand	100	cft	20.00	2000.00
4	Stone 3/8"	70	cft	75.00	5250.00
5	ISMC 75	200	kg	42.00	8400.00
6	M.S. Rod 10 mm	20	kg	40.00	800.00
7	Aluminum Channel framing with 5 mm thick glass fitting in wall	736	sqft	258.00	189888.00
8	AC board ceiling 2'x2' with GI /aluminium framing	465	sqft	58.00	26970.00
9	Floor tiles 2'x2' vitrified	600	sqft	58.00	34800.00
10	Sanitary items	L.s	L.s.		15000.00
11	Electrical Items	Ls	Ls		22000.00
12	Windows	1	set	5000.00	5000.00
13	Doors	1	no	5000.00	5000.00
14	Light & Plung point wiring with 1.5 & 2.5 mm <sup>2</sup> copper wire with PVC casing, switch & board etc complete fitting with ISI marked	12	points	2500.00	30000.00
15	Distemper for Wall & Ceiling (Asian paint)	50	kg	65.00	3250.00
16	Synthetic paint (Asian paint)	4	Lt	350.00	1400.00
17	Glass for Windows 4mm	24	sqft	36.00	864.00
18	Hardware goods	L/s			4000.00
	Cost of Materials				376622.00
	Labour Charge				65000.00
	Grand Total				441622.00

*Dibya Jyoti Borah*  
Dibya Jyoti Borah, B.E. (Civil)  
Regd. No. 513/91-92  
Consultant Engineer  
Andrew Yule & Co. Ltd (Assam Garden)

**BASMATIA TEA ESTATE**  
**Andrew Yule & Co. Ltd**  
**P.O. Lahoal, Dist. Dibrugarh, Assam – 786 010**

**DRAWING FOR EXTENSION OF FERMENTING AREA AND CONSTRUCTION OF**  
**NEW FACTORY OFFICE**

**Ref. Tender No.: BS/CAPEX/17-18/1**

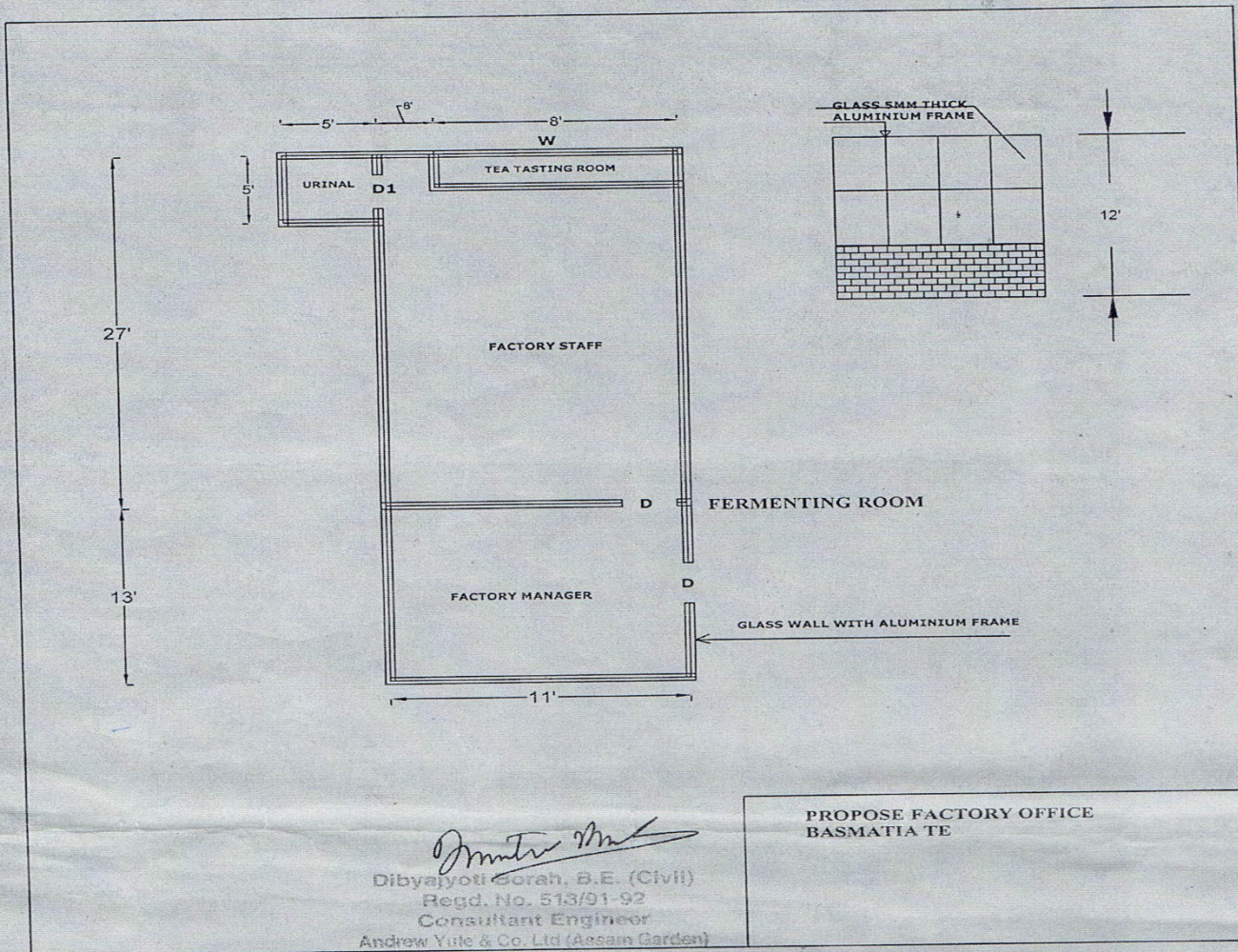

*Dibyajyoti Borah*  
Dibyajyoti Borah, B.E. (Civil)  
Regd. No. 513/91-92  
Consultant Engineer  
Andrew Yule & Co. Ltd (Assam Garden)

PROPOSE FACTORY OFFICE  
BASMATIA TE